

Catalogue rev. 21-01-2014

THE
PERMANENT
VALUE

ADI

INDUSTRIAL DIAMOND APPLICATION

Ultra Compact Surfaces
Tools Technology



Turbo Segmented Diamond Blades for ULTRA COMPACT SURFACES

<i>ADI Code</i>	<i>Description</i>	<i>RPM</i>	<i>FEED</i> [mm/min]
MT64015	Φ350 Bore Φ60	1.400	1.000-1.200
MT64016	Φ400 Bore Φ60	1.200	1.000-1.200



Continuous Rim Diamond Blades for ULTRA COMPACT SURFACES

<i>ADI Code</i>	<i>Description</i>	<i>RPM</i>	<i>FEED</i> [mm/min]
MT60012	Φ350 Bore Φ60	1.300 - 1.600	1.000-1.200
MT60005	Φ400 Bore Φ60	1.200 - 1.500	1.000-1.200



Segmented Diamond Blades for ULTRA COMPACT SURFACES

<i>ADI Code</i>	<i>Description</i>	<i>RPM</i>	<i>FEED</i> [mm/min]
MT64005	Φ350 Bore Φ60	1.300-1.600	800-1.200
MT64003	Φ400 Bore Φ60	1.200-1.500	800-1.200



Core Drill for ULTRA COMPACT SURFACES

<i>ADI Code</i>	<i>Description</i>	<i>RPM</i>	<i>FEED</i> [mm/min]
MT81135	D.35 LT=75 A=1/2"	1.800 -2.200	15-30



New Segmented Finger Bit UHS for ULTRA COMPACT SURFACES

<i>ADI Code</i>	<i>Description</i>	<i>RPM</i>	<i>FEED</i> [mm/min]
MT74010	19x25 A=1/2" GAS	4.000 - 5.000	150 - 250



Incremental Finger Bit for ULTRA COMPACT SURFACES

ADI Code	Description	RPM	FEED [mm/min]	Stock Removal [mm]
MT75015	1A1W FC $\Phi 6 \times 10$ LU= 25 A=1/2" GAS	6.000 - 7.000	150 - 200	2 Max
MT75016	1A1W FC $\Phi 8 \times 10$ LU= 25 A=1/2" GAS	6.000 - 7.000	150 - 200	2 Max
MT75017	1A1W FC $\Phi 10 \times 10$ LU= 25 A=1/2" GAS	6.000 - 7.000	150 - 200	2 Max
MT75018	1A1W FC $\Phi 12 \times 10$ LU= 25 A=1/2" GAS	6.000 - 7.000	150 - 200	2 Max



Drain Board Wheels for ULTRA COMPACT SURFACES

ADI Code	Description	RPM	FEED [mm/min]	Stock Removal [mm]
MT73011	Super Duty $\Phi 54 \times 25 \times 7$ F=14	6.000 - 6.500	600 - 1.000	1 to 4 Max
MT73012	Super Duty $\Phi 91 \times 30 \times 7$ F=50	4.500 - 5.000	400 - 600	1 to 4 Max

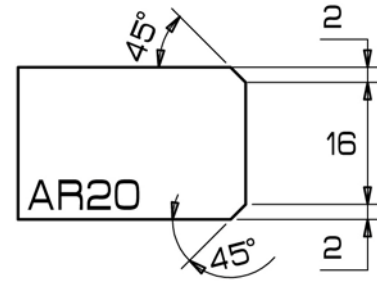
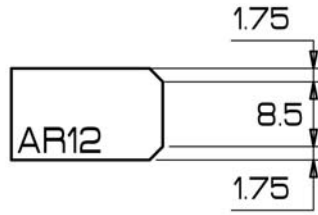
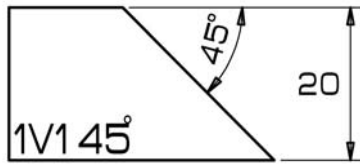

Pos	Type	Code	ED mm	ID mm
1	SEG	MT91027	120	82
2	C+S	MT91028	120	72
3	C+S	MT91029	120	72

Pos	Type	Code	ED mm	ID mm
1	C+S	MT91023	80	75
2	C+S	MT91024	80	75
3	C+S	MT91025	80	75
4	C+S	PB123546	80	75
5	Exp	PB02321	67	60
6	Exp	PB02322	67	60
7	Exp	PB02323	67	60

Pos	Type	Code	ED mm	ID mm
1	C+S	MT91005	78	70
2	C+S	MT91006	78	70
3	C+S	MT91007	78	70
4	C+S	PB122850	78	70
5	Exp	PB02013	68	60
6	Exp	PB02014	68	60
7	Exp	PB02015	68	60

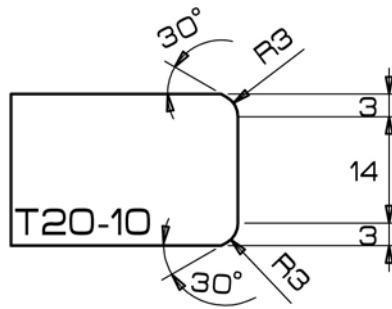
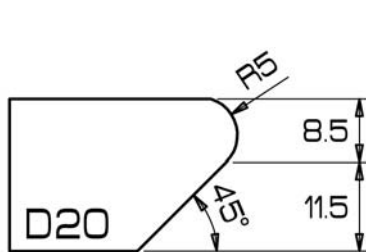

Pos	Type	Code	ED mm	ID mm
1	SET	MT91011	120	87
2	C+S	MT91012	120	87
3	C+S	MT91013	120	87
4	C+S	PB122701	120	87
5	Exp	PB02052	91	60
6	Exp	PB02053	91	60
7	Exp	PB02054	91	60

Pos	Type	Code	ED mm	ID mm
1	SET	MT91016	71	60
2	C+S	MT91017	71	60
3	C+S	MT91018	71	60
4	C+S	PB124180	71	60
5	Exp	PB021349	75	60
6	Exp	PB021350	75	60
7	Exp	PB021351	75	60

Pos	Type	Code	ED mm	ID mm
1	SET	MT91008	80	80
2	C+S	MT91009	80	80
3	C+S	MT91010	80	80
4	C+S	PB122878	80	80
5	Exp	PB02403	80	80
6	Exp	PB02404	80	80
7	Exp	PB02405	80	80

Working Parameters for Tools for UCS Materials

<i>Description</i>	<i>RPM</i>	<i>FEED</i> [mm/min]	<i>Stock</i> <i>Removal</i> [mm]
UCS TOP LINE POS.1	5.000	400	On Shape
UCS TOP LINE POS.2	5.000	800	0,3
UCS TOP LINE POS.3	5.000	800	0,1
UHS TOP LINE POS.4	5.000	800	0,05-0,01
UCS FAST LINE POS.1	5.500	400	On Shape
UCS FAST LINE POS.2	5.500	800	0,3
UCS FAST LINE POS.3	5.500	800	0,1
UHS FAST LINE POS.4	5.500	800	0,05-0,01
EXPRESS POS.6	2.500-3.000	1.200 - 1.500	0.03 - 0.05
EPRESSS POS.7	2.500-3.000	1.200 - 1.500	0.03 - 0.05



ADI S.p.A.
Via dell'Economia, 12/16 - 36016 Thiene (VI) Italy
Tel: +39.0445.360244 Fax: +39.0445.366862
info@aditools.com - www.aditools.com

ADI USA Inc.
1477 Connolly Springs Rd 28645 Lenoir / North Carolina - USA
Tel. 1-828-7284711 - Fax 1-828-7289613
info@aditools-usa.com - www.aditools-usa.com