

Catalogue 2015

THE
PERMANENT
VALUE

ADI

INDUSTRIAL DIAMOND APPLICATION

ADVANCED **STONE**
TOOLS TECHNOLOGY

CNC Blades

INDEX

Electroplated Diamond Blades for Marble and Fiber Glass	Page	5
Segmented Diamond Blades for Granite and Engineered Stone	Page	6
Electroplated Saw Blades to Shape for Marble	Page	7
Segmented Saw Blades to Shape for Marble and Granite	Page	8
Convex Blades for Granite and Engineered Stone	Page	9

Electroplated Diamond Blades for Marble
and Fiber Glass

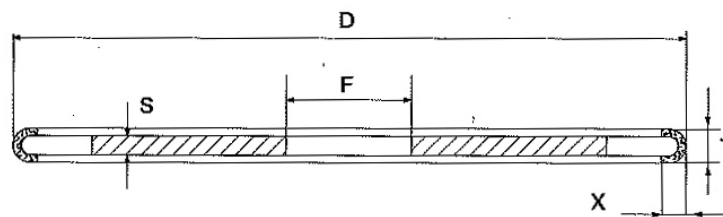

ADI CODE	DIMENSION [D]	Fitting [mm]	Core Thickness (S) [mm]	Diamond Thickness (T) [mm]	Diamond Height (X) [mm]	RPM	FEED [mm/min]
PF05090	240	30	1,8	3,0	3,0	3.500-4.000	300-600
PF05002	290	30	1,8	3,0	3,0	2.900-3.500	300-600
PF05016	340	30	2,2	3,4	3,5	2.500-3.000	300-600
PF05017	390	50/30	2,5	3,7	3,5	2.200-2.700	300-600
PF05143	440	50/30	2,8	4,0	3,5	1.800-2.300	300-600
PF05018	490	50/30	2,8	4,0	3,5	1.500-1.800	300-600
PF05144	540	50/30	3,5	4,5	3,5	1.300-1.500	300-600
PF05145	590	50/30	3,5	4,5	3,5	1.100-1.300	300-600

Segmented Diamond Blades for Granite and Engineered Stone

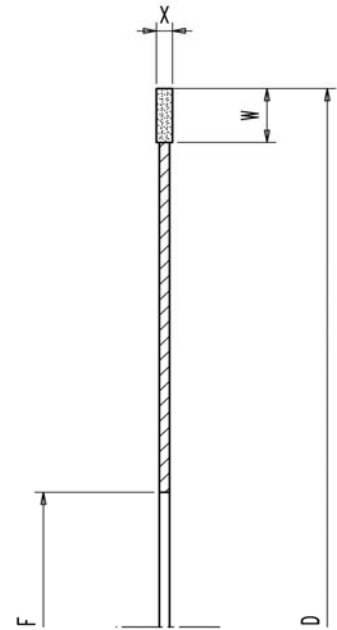

Blades for Granite

ADI CODE	DIMENSION [D]	Fitting [mm]	Machine	Diamond Thickness (X) [mm]	Diamond Height (W) [mm]	RPM	FEED [mm/min]
PH02119	150	22	Intermac	4	5	3.000-3.500	500-700
PH02155	150	25	Park Industries	4	5	3.000-3.500	500-700
PH02185	200	50	Denver/Thibaut	2,8	10	2.400-2.900	700-1.000
PH01032	210	28	Ravelli Teorema	2,8	10	2.400-2.900	700-1.000
PH02111	210	50	Brembana	2,8	10	2.400-2.900	700-1.000
PH02253	210	22,2	Bavelloni	3	10	2.400-2.900	700-1.000
PH02095	210	50	Breton	2,8	10	2.400-2.900	700-1.000
PH02148	260	50	Breton	2,8	10	2.000-2.300	700-1.000
PH02078	.350	50	Breton	3,2	10	1.500-1.800	800-1.200

Blades for Engineered Stone

PH02508	210	30	Intermac	2,8	10	2.400-2.900	700-1.000
PH02152	260	50	Breton	2,8	10	2.000-2.300	700-1.000
PH02151	350	50	Breton	3,2	10	1.500-1.800	800-1.200

Electroplated Saw Blades to Shape for
Marble

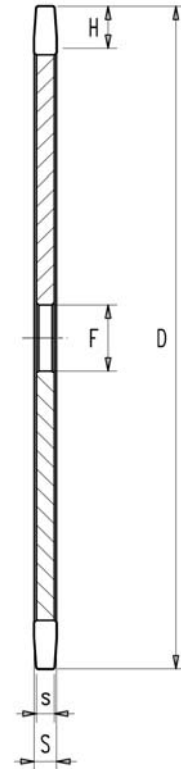

ADI CODE	DIMENSION [D]	Fitting [F] [mm]	Core Thickness (S) [mm]	Head Thickness (s) [mm]	Diamond Height (H) [mm]	Diamond Grit	RPM
PF05516	300	50/30	10	8	19	D427	2.900-3.500
PF05508	350	50/30	10	8	19	D427	2.500-3.000
PF05517	400	50/30	11	8	20	D427	2.200-2.700
PF05524	450	50/30	12	9	20	D427	1.800-2.300
PF05525	500	50/30	14	11	20	D427	1.500-1.800
PF05515	300	50/30	10	8	19	D602	2.900-3.500
PF05520	350	50/30	10	8	19	D602	2.500-3.000
PF05507	400	50/30	11	8	20	D602	2.200-2.700
PF05509	450	50/30	12	9	20	D602	1.800-2.300
PF05510	500	50/30	14	11	20	D602	1.500-1.800

Segmented Saw Blades to Shape for Marble
and Granite

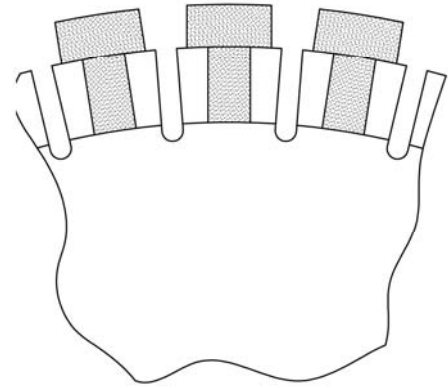
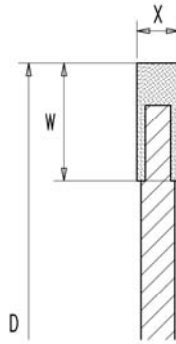

ADI CODE	DIMENSION [D]	Fitting [F] [mm]	Head Thickness (X) [mm]	Diamond Height (W) [mm]	Material	RPM
PC10806	350	50	10	28	Marble	2.500-3.000
PC10804	400	50	10	28	Marble	2.200-2.700
PC10807	500	50	10	28	Marble	1.700-2.100
PC10501	350	50	10	28	Granite	1.400-1.800
PC10502	400	50	10	28	Granite	1.200-1.700
PC10511	500	50	10	28	Granite	1.000-1.300

Convex Blades for Granite and Engineered Stone

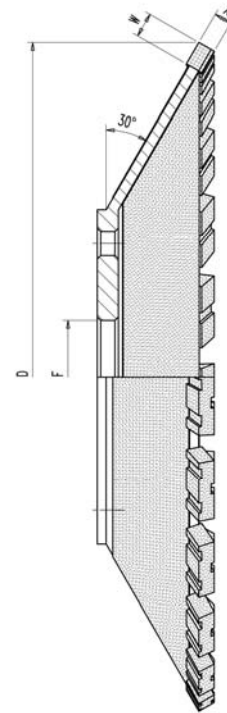

ADI CODE	DIMENSION [D]	Fitting [mm]	Machine	Diamond Thickness (X) [mm]	Diamond Height (W) [mm]	RPM	FEED [mm/min]
PF06049	190	32	Breton - Omag	5	7	3.200	500-600
PF06054	190	50	Cms Brembana	5	7	3.200	500-600
PF06056	190	30	Intermac	5	7	3.200	500-600
PF06064	190	50	Vem - Denver - Thibaut	5	7	3.200	500-600
PF06062	155	22	Bavelloni	5	7	3.200	250-300



ADI S.p.A.
Via dell'Economia, 12/16 - 36016 Thiene (VI) Italy
Tel: +39.0445.360244 Fax: +39.0445.366862
info@aditools.com - www.aditools.com

ADI USA Inc.
1477 Connelly Springs Rd 28645 Lenoir / North Carolina - USA
Tel. 1-828-7284711 - Fax 1-828-7289613
info@aditools-usa.com - www.aditools-usa.com